



## PLATINUM COURT, CEPHAS AVENUE E1

### 1 BED APARTMENT

£1,700

One bedroom apartment is set on the lower ground of a purpose built block moments from the City and multiple transport links.

The flat comprises of a large living room, open plan kitchen, a good size double bedroom, private patio garden and a shower room. The City can be reached easily by foot for those that want an easy commute into Aldgate and Liverpool Street, but Stepney Green is also on the doorstep as well as all the amenities on Whitechapel Road.

**Hemmingfords**

## Cephas Avenue, E1 4FF

Approx Gross Internal Area = 31.2 sq m / 336 sq ft

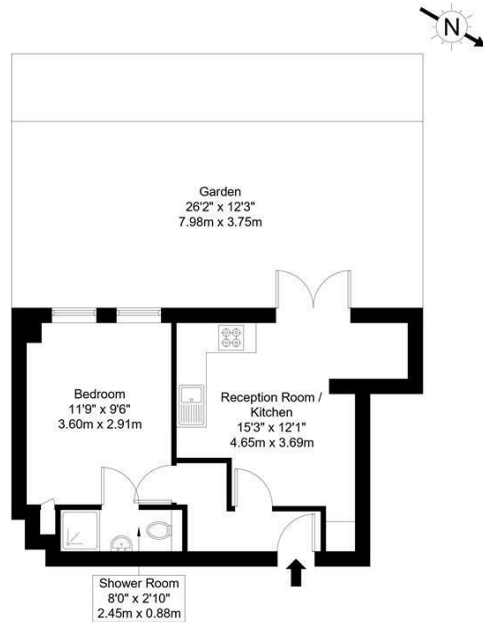

Lower Ground Floor

Ref :

Copyright

**B L E U  
P L A N**

The Floor plan is not to scale and measurements and areas shown are approximate and therefore should be used for illustrative purposes only. The plan has been prepared in accordance with the RICS code of Measuring Practice and whilst we have confidence in the information produced it must not be relied on. Maximum lengths and widths are represented on the floor plan. If there is any aspect of particular importance, you should carry out or commission your own inspection of the property.  
Copyright © BleuPlan

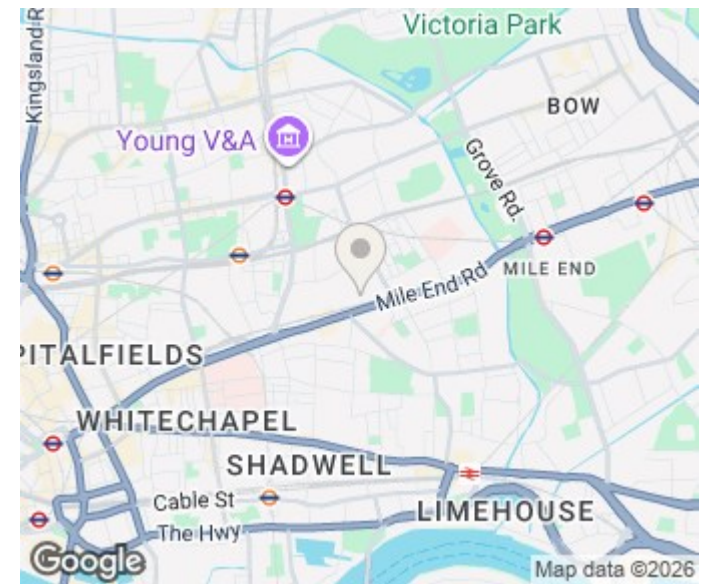

Energy Efficiency Rating		
	Current	Potential
Very energy efficient - lower running costs		
(92 plus) <b>A</b>		
(81-91) <b>B</b>		
(69-80) <b>C</b>	<b>78</b>	<b>78</b>
(55-68) <b>D</b>		
(39-54) <b>E</b>		
(21-38) <b>F</b>		
(1-20) <b>G</b>		
Not energy efficient - higher running costs		
<b>England &amp; Wales</b>	EU Directive 2002/91/EC	

Agents Note: Whilst every care has been taken to prepare these particulars, they are for guidance purposes only. All measurements are approximate and are for general guidance purposes only and whilst every care has been taken to ensure their accuracy, they should not be relied upon and potential buyers/tenants are advised to recheck the measurements

Hemmingfords Lettings  
34 Upper Street  
London  
N1 0PN

020 3890 7470  
info@hemmingfords.co.uk  
www.hemmingfords.co.uk

**Hemmingfords**